

**ICAO Medium Intensity Type B, FAA L-864 and L-885,
2 000 cd red LED flashing obstacle light****Key features**

- Based on LED-technology
- 2 000 cd flashing with CSW flash controller unit, power supply PS-230-x-3A5-PCFL or stand-alone photocell and flasher PCFL-DC1-TB
- Extremely reliable - long lifetime
- Very low power consumption
- Stabilised light output
- Lightweight and small – low wind load factor
- Easy to install
- No RF-radiations
- Long maintenance intervals
- Comes with five (5) years warranty
- Patented

Specifications met

- ICAO International Standards and Recommended Practices: Aerodromes - Annex 14 Volume 1, 5th Edition, July 2009, Chapter 6: Medium-intensity, Type C Fixed Obstacle Light
- FAA Advisory Circular 150/5345-43F 09/12/06: L-864 and L-885 light unit
- Certified by STAC France and FVT Germany

Optical characteristics

- Intensity 2000 cd
- Colour aviation red
- Horizontal radiation pattern 360°
- Vertical radiation pattern 3°

Electrical characteristics

- Input voltages: 24 Vdc (22...30 V), 48 Vdc (47...58 V)
- Power consumption 5.6 W @ 20 fpm and 250 ms
- Operating temperature range -40...+55 °C
- Three-stage overvoltage protection
- LEDs in several separate groups
- LED supply current stabilised by constant current generator

Mechanical characteristics

- Anodised aluminium body
- Glass cover
- Terminal box for 1.5...6 mm² wires
- Degree of protection IP65
- Height 284 mm, diameter 154 mm,
- Mounting set -V or -H and terminal box include
- Light unit weight 3 kg without mounting set
- Wind load 500 N with mounting set @ 200 km/h

Made in Finland**Obelux MI-2KR-F without mounting set****Options**

- CSW-x-x-F flash controller
- CSW-x-x-F-GPS flash controller with global flash sequency synchronisation by GPS-UTC time
- CSW-x-x-F-GSM controller with GSM communication
- PS-230-x-3A5 power supply
- PS-230-x-3A5-PCFL power supply with flash controller and photocell
- PCFL-DC1-TB stand-alone photocell and flash controller
- Battery back-up system
- Solar operated power supply system (SPOL)
- Mounting sets (MS)

Order codes:

Obelux MI-2KR-024-F-V for 24 Vdc system with vertical MS
Obelux MI-2KR-024-F-H for 24 Vdc system with horizontal MS

Obelux MI-2KR-048-F-V for 48 Vdc system with vertical MS
Obelux MI-2KR-048-F-H for 48 Vdc system with horizontal MS

Technical information in this document is subject to change without notice. Copyright © Obelux Oy 2012

**ICAO Medium Intensity Type B, FAA L-864 and L-885,
2 000 cd red LED flashing obstacle light**

Obelux MI-2KR-xxx-F is an obstacle light utilizing LED technology. The cabling and installation principles are similar to those of conventional obstacle lights, the only exception being the correct polarity required by DC feed.

Terminal box include screw terminals and overvoltage protectors.

The polarity is:

- Blue -
- Black +
- Yellow-Green PE

All connection alternatives can be protected with a 6 A or 10 A fuse or with a circuit breaker (C curve).

Installation specifications

- Cable gland: M25
- Cable diameter: 11...17 mm
- Wire diameter: max. 6 mm²
- Recommended cable: 2x1.5+1.5 or 2x2.5+2.5 mm²

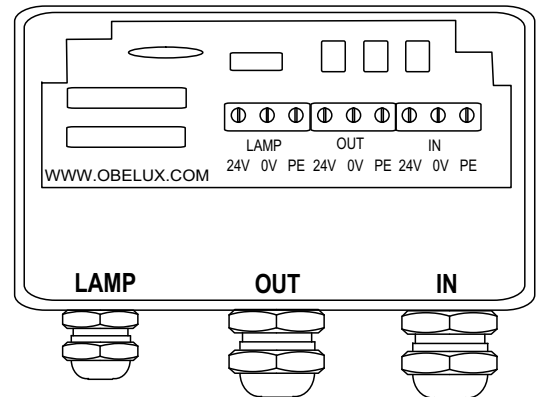

Cable Gland
M20 for 8-13 mm
cable

Cable Gland
M25 for 11-17 mm
cable

Cable Gland
M25 for 11-17 mm
cable

Terminal box

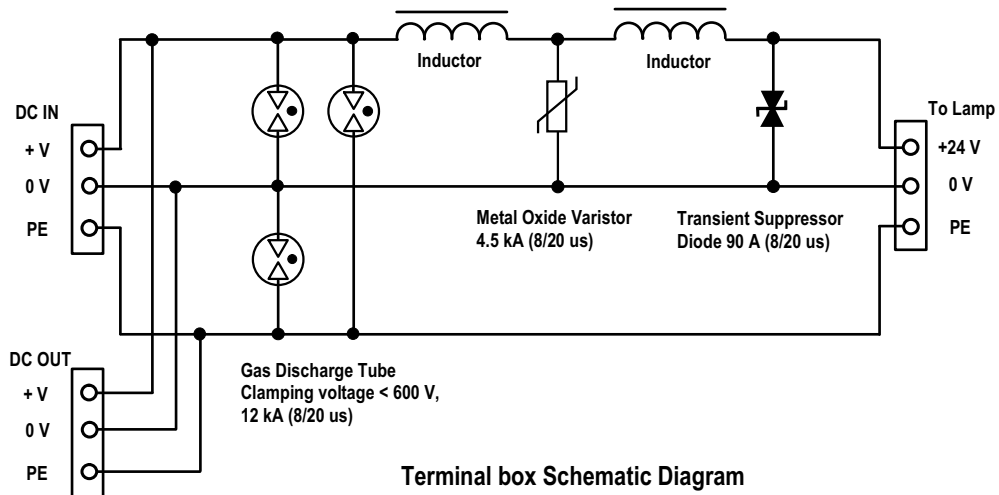

Terminal box Schematic Diagram

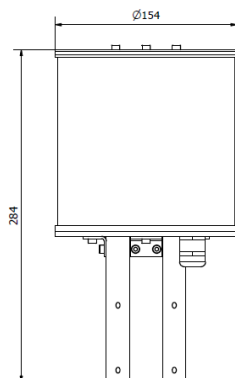

Technical information in this document is subject to change without notice. Copyright © Obelux Oy 2012

Obelux MI-2KR-xxx-F-V
Light unit with -V mounting set. Mounting to Vertical pipe

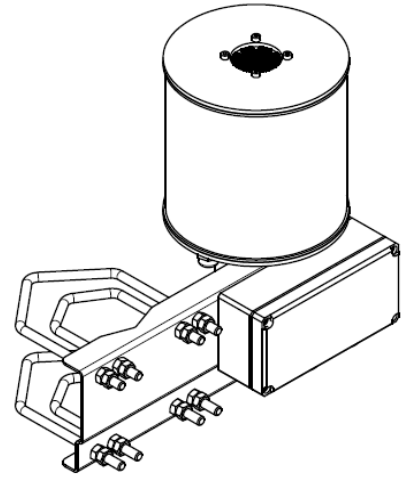

Mounting plate, U-bolts, hex nuts: Acid Proof steel
Terminal box: Polycarbonate
Mounting set weight: 0.7 kg

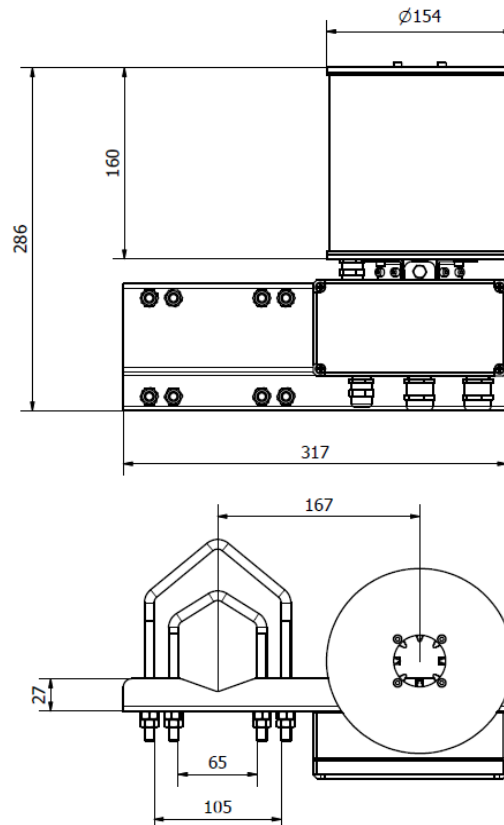

Technical information in this document is subject to change without notice. Copyright © Obelux Oy 2012

Obelux MI-2KR-xxx-F-H
Light unit with -H mounting set. Mounting to Horizontal plate by L-shape brackets

Mounting plate: Aluminium
U-bolts, hex nuts: Acid Proof steel
Terminal box: Polycarbonate
Mounting set weight: 0.3 kg

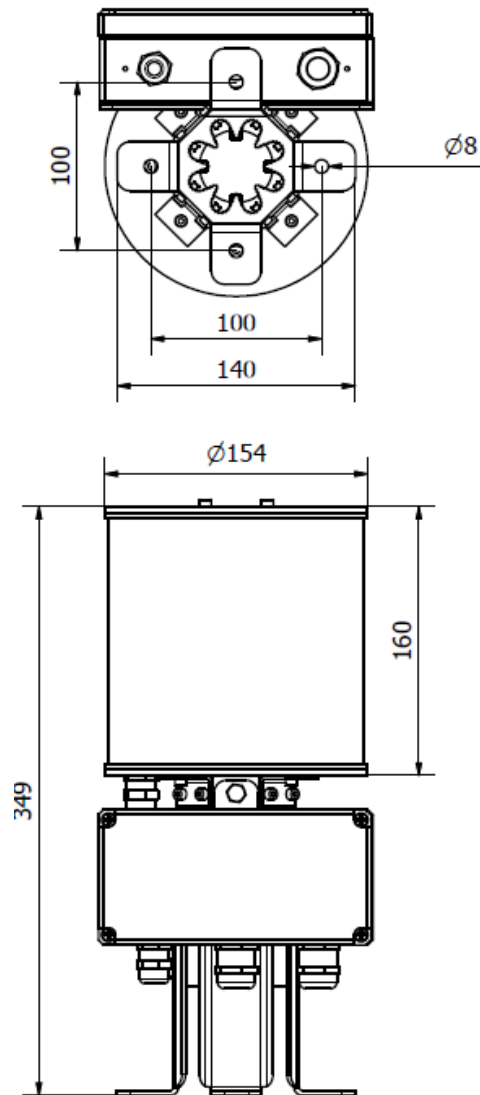

Technical information in this document is subject to change without notice. Copyright © Obelux Oy 2012